

1. PRESENT TIME AND DATE

- (1)SET DAY OF WEEK
PRESS CLOCK KEY AND DAY KEY, THE DAY OF WEEK WILL BE CHANGED FROM MO TO SU. RELEASE KEYS, THE DAY OF WEEK WILL BE SET.
- (2)SET HOUR
PRESS CLOCK KEY AND HOUR KEY, THE HOUR WILL BE CHANGED. HOLD CLOCK AND HOUR KEYS, THE HOUR WILL SHIFT FAST. RELEASE KEYS THE HOUR WILL BE SET.
- (3)SET MINUTE
PRESS CLOCK KEY AND MINUTE KEY, THE MINUTE WILL BE CHANGED. HOLD CLOCK AND MINUTE KEYS, THE MINUTE WILL SHIFT FAST. RELEASE KEYS THE MINUTE WILL BE SET.

2. TO SET PROGRAMS

- (1)PRESS TIMER KEY TO ENTER INTO PROGRAM MODE.
- (2)PROGRAM 1ON TIME IS READY FOR SETTING:
 - a. PRESS DAY KEY TO SELECT THE DAY OF WEEK, THERE ARE 10 FOR CHOICE: 1-MO; 2-TU; 3-WE; 4-TH; 5-FR; 6-SA; 7-SU; 8-SA+SU; 9-MO+TU+WE+TH+FR; 10-MO TO SU.
 - b. PRESS HOUR KEY TO SET HOUR. PRESS MINUTE KEY TO SET MINTUE.
- (3)AFTER PROGRAM 1ON TIME SETTING, PRESS TIMER KEY INTO SET PROGRAM 1OFF TIME: REPEAT a. TO b. TO SET THE PROGRAM 1OFF TIME.
- (4)AFTER SETTING PROGRAM 1ON/OFF TIME, REPEAT ABOVE STEP TO PROGRAM 2 TO 6.
- (5)AFTER ON/OFF SETTING, PRESS CLOCK KEY THEN RETURN PRESENTS TIME.

3. IF USER WANTS TO MAKE CORRECTION OR DELETION OF DAY AND SETTING TIME, THE OPERATING PROCEDURES AS FOLLOWS.

- (1)PRESS TIMER KEY TO FIND RESETING LOCATION.
- (2)PRESS RESET KEY FOR AUTOMATICALLY APPEARING “- | -” IN THE SCREEN.
- (3)INPUT THE NEW DAY OR TIME YOU REQUEST.

4. TO SELECT ON/AUTO/OFF MODE

- (1)PRESS MANUAL KEY TO SELECT ON/AUTO/OFF MODES.
- (2)ON MODE SET OUTPUT AT ON STATE.

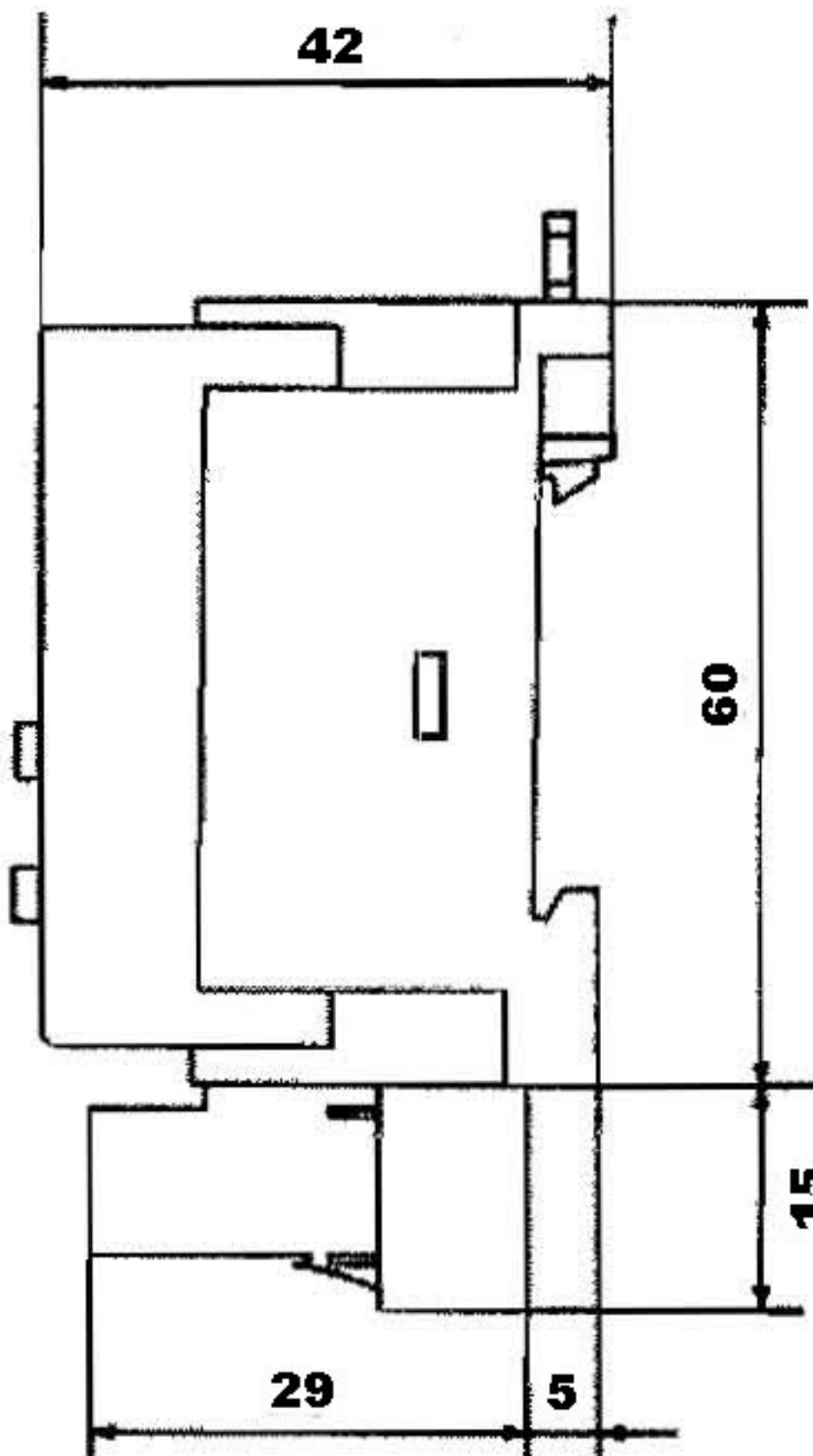
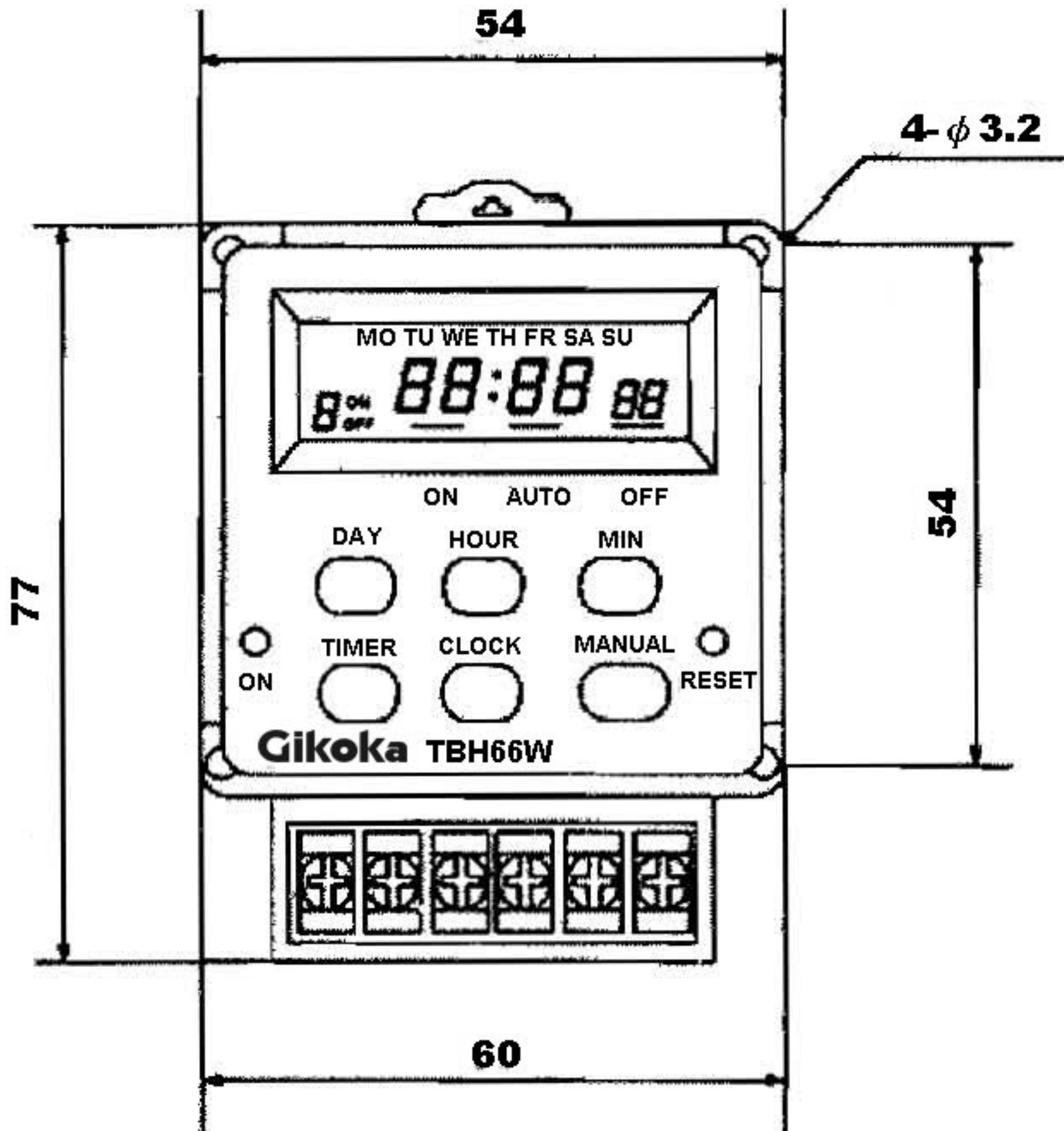

- ※ OFFERING 6 ON/OFF PROGRAMMABLE SETTING AVAILABLE TO SWITCH INSIDE CONTACTS TO BE CLOSE OR OPENED WHENEVER ON EACH DAY OR WEEK DAY OR WEEKEND SEPARATELY.
- ※ ON.OFF SETTING SHOULD BE IN SEQUENCE OF “ON1, OFF1; ON2, OFF2...ON6, OFF6 CLOCKWISE AND LOGICALITY.

KEYBOARD	MODE	
	CLOCK MODE	6 SETTING TIMER MODE
CLOCK	INEFFECTIVE	INTO CLOCK MODE
TIMER	INTO TIMER ON	INTO TIMING CYCLE 1ON→1OFF→2ON→2OFF→3ON→3OFF→4ON →4OFF→ 5ON→5OFF→6ON→6OFF→1ON
DAY	PRESS“DAY”INEFFECTIVE PRESS“CLOCK+DAY”TO ADJUST DAY OF A WEEK.	ADJUSTABLE FOR ACTION DAY (1)MO (2)TU (3)WE (4)TH (5)FR (6)SA (7)SU (8)MO+TU+WE+TH+FR (9)SA+SU (10)MO+TU+WE+TH+FR+SA+SU
HOUR	PRESS“HOUR”INEFFECTIVE PRESS“CLOCK+HOUR”TO ADJUST HOURS.	PRESS“HOUR”TO ADJUST HOURS.
MIN	PRESS“MIN”INEFFECTIVE PRESS“CLOCK+MIN”TO ADJUST MINUTES	PRESS“MIN”TO ADJUST MINUTES.
RESET	RESET OR CHANGE PROGRAM.	
MANUAL	TO CHANGE THE OUTPUT OF RELAY:ON-AUTO-OFF.	

- (3)OFF MODE SET OUTPUT AT OFF STATE.
 - (4)AUTO MODE SET OUTPUT TO PROGRAM MODE. IT WILL TURN ON/OFF ACCORDING TO THE PROGRAM TIME.
 - (5)AFTER PROGRAM SETTING IS CONFIRMED. IT IS NECESSARY TO PRESS MANUAL KEY AND CHANGE THE MODE. PLEASE CHECK THE PRESENT TIME. IF IT IS IN THE DURATION OF PROGRAM ON TIME THEN PRESS MANUAL KEY TO MAKE IT FROM ON TO AUTO. IN CASE OF PRESENT TIME IS IN OFF TIME THEN MAKE IT FROM OFF TO AUTO MODE. BECAUSE FROM ON TO AUTO IT WILL ON TIMER, AND FROM OFF TO AUTO IT WILL TURN OFFTIMER. THIS IS VERY IMPORTANT TO BE CORRECT RESPONDENCE ACCORDING TO YOUR SETTING.
 - (6)WIRE CONNECTION PLEASE SEE THE DIAGRAM
 - a. CONTACT RATING: AC 250V 5A AC 120V 7A
 - b. THE APPLIED VOLTAGE RANGE: 100~250V AC
 - c. INSIDE BATTERY: JUST FOR CLOCK RUNNING NOT FOR OUTPUT ON/OFF SWITCHING.
- 5.CAUTION!
- FOR THE FIRST TIME OR WHEN POWER FAILURE OVER ABOUT 150Hrs. PLEASE CHECK THE MONITOR,IF THE MONITOR HAS NO DIGITAL DISPLAY,PLEASE CHARGE BATTERY TILL THE MONITOR HAS DIGITAL DISPLAY,WHEN CHARGE BATTERY OR SETTING PROGRAM OR CHANGE PROGRAM,PLEASE DON'T CONNECT ANY LOAD AT ANY TIME.

● WIRE CONNECTION

